

Parcela (1) INVENTAR COORDONATE NC 201293

Nr. Pct.	Coordonate pct.de constr.	Lungimi lateri D(i,i+1)
126	329378.645 590339.264	20.199
111	329396.501 590348.707	41.526
105	329378.718 590386.233	20.109
119	329360.695 590377.315	6.429
118	329363.321 590371.447	24.022
151	329373.545 590349.709	11.624

S(1)=846.67mp P=123.905m

- LIMITE**
- [Red dashed line] limita teren care a generat PUD S=846.65mp
 - [Black dashed line] zona studiata
 - [Blue line] limita parcele
 - [Red dashed line] aliniament
 - [Red dashed line] retragere parter fatada posterioara

- FUNCTIUNI EXISTENTE**
- [Yellow box] locuinte individuale pe parcela
 - [Orange box] locuinte colective pe parcela
 - [Yellow box with X] anexa gospodareasca/garaj
 - [Blue box] constructii educatie
- CAI DE COMUNICATII**
- [Purple box] circulatie auto
 - [Pink box] circulatie pietonala

BILANT TERITORIAL PROPOS

Funciunea	Suprafata(mp)	%
S.construita	335,80	40,00
S.sp.plantat la sol	178,50	21,08
S.circulatii	332,35	38,92
Total	846,65	100,00

BILANT SPATIU VERDE

Spatiu verde pe sol adanc	= 178,50mp	= 21,08%
Spatiu verde pe placi si terase	= 90,80mp	= 10,72%
S.sp.verde total (% din S teren)		= 31,80%

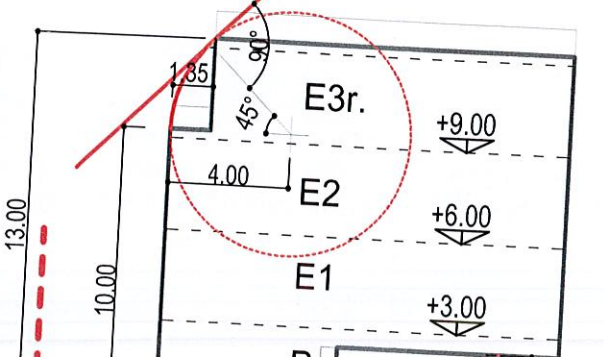
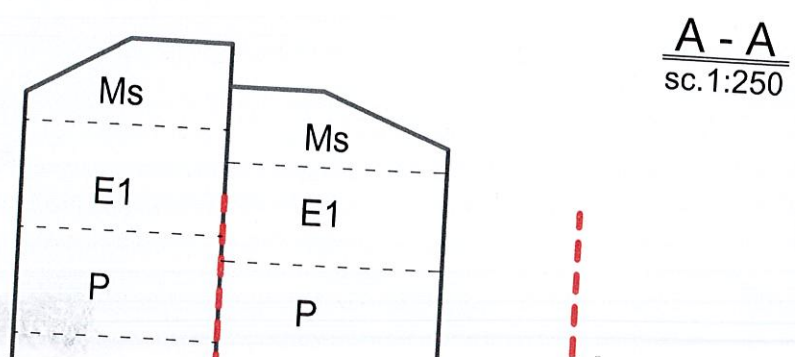

Conform R.L.U. aferent P.U.G. Bucuresti subzona mixta cu cladiri avand regim de maxim de P+4 niveluri
 Utilizari admise: locuinte cu partiu obisnuit profesii liberale;
 Amplasarea cladirii fata de aliniament: